

Cross cylindrical roller slewing bearing internal gear

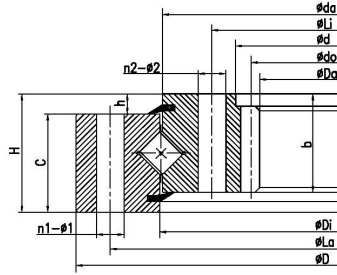

Выбрать	запрос	Bearing Model		Граничные размеры (мм)				Bolt hole diameter (mm)					Structure dimensions (mm)						Gear Parameters (mm)				Basic load rating Coa (KN)	Масса (KG)			
		Model	INA Model	Da	D	ди	ЧАС	Ли	n1	n2	$\phi 1$	$\phi 2$	Ла	Д1	д:	б	час	Б:	С	Ди	да	м			г	делать	Икс
XIU10/288	XI120288N	216	340	38	324	252	20	20	9	9			34	5	34	33	289	287	4	56	224		340	12			
XIU15/400		304	475	55	448	352	16	16	13.5	13.5			46	9	46	46	402	398	4	77	308	-0.5	490	31			
XIU15/414	XS1140414N	325	484	56	460	375	24	24	14	M12*20		350	40	11.5	44.5	44.5	415	411	5	67	335		520	31			
XIU10/420	XI120420N	332	486	38	462	378	16	16	14	14			34	5	34	33	421	419	4	85	340		500	24			
XIU20/450		336	536	62	505	395	16	16	15.5	15.5			53	9	53	53	452	448	6	57	342	-0.5	760	48			
XIU15/450		345	531	55	500	400	16	16	15.5	15.5			46	9	46	46	452	448	5	70	350	-0.5	560	40			
XIU25/500Y		360	602	75	566	434	20	20	18	18		398	60	10	65	65	501	499	6	62	372	0.5	1040	80			
XIU25/500		365	602	75	566	434	20	20	18	18		398	60	10	65	65	501	499	5	74	370	0.5	1040	80			
XIU15/489	XI160489N	384	562	45	538	440	40	40	14	14			40	5	40	40	490	488	6	66	396		710	35			
XIU20/489		385	562	60	538	440	30	30	$\phi 13.5$	$\phi 13.5$	560	418	43	10	50	50	490	487	6	66	396		1050	42.7			
XIU25/560		425	662	75	626	494	20	20	18	18			458	60	10	65	65	561.5	558.5	5	86	430	0.5	1160	90		
XIU25/560Y		426	662	75	626	494	20	21	18	18		458	60	10	65	65	561.5	558.5	6	112	672	0.5	1160	90			
XIU15/544	XS1140544N	444	614	56	590	505	32	32	14	M12*20			44.5	11.5	44.5	44.5	545	541	6	76	456		680	43			
XIU20/560		444	646	62	615	505	20	20	15.5	15.5			53	9	53	53	562	558	6	75	450	-0.5	950	60			
XIU15/560		455	641	55	610	510	20	20	15.5	15.5			46	9	46	46	562	558	5	92	460	-0.5	680	49			
XIU20/573		457	665	60	630	517	28	28	$\phi 17.5$	$\phi 17.5$	660	485	45	10	50	50	575	571	6	77	462	0.5	1050	60			
XIU15/575	XI140575N	462	657	45	625	525	16	16	18	18			38	7	38	38	576	574	6	79	474		830	45			
XIU25/630Y		488	732	75	696	564	24	24	18	18		528	60	10	65	65	631.5	628.5	8	62	496	0.5	1300	100			
XIU25/630		492	732	75	696	564	24	24	18	18		528	60	10	65	65	631.5	628.5	6	83	498	0.5	1300	100			
XIU20/630		496	722	62	687	573	20	20	17.5	17.5			53	9	53	53	632	625	8	63	504	-0.5	1100	75			
XIU20/635	XI180635N	504	722	54	690	580	24	24	18	18			47	7	47	47	636	634	8	65	520		1040	65			
XIU15/630		516	717	55	682	578	20	20	17.5	17.5			46	9	46	46	632	628	6	87	522	-0.5	800	59			
XIU15/644	XS1140644N	546	714	56	690	605	36	36	14	M12*20			44.5	11.5	44.5	44.5	645	641	6	93	558		800	50			
XIU30/713	XI300713N	560	817	80	785	640	52	52	18	18			73	7	73	73	714	712	10	58	580		1980	130			
XIU25/710Y		568	812	75	776	644	24	24	18	18		608	60	10	65	65	711.5	708.5	8	72	576	0.5	1490	110			
XIU25/710		570	812	75	776	644	24	24	18	18		608	60	10	65	65	711.5	708.5	6	96	576	0.5	1490	110			
XIU20/710		576	802	62	767	653	24	24	17.5	17.5			53	9	53	53	712	708	8	73	584	-0.5	1280	84			
XIU20/720	XI200720N	584	812	58	780	660	40	40	18	18			51	7	51	51	721	719	8	75	600		1420	80			
XIU30/800Y		630	922	82	878	722	30	30	22	22		678	65	10	72	72	801.5	798.5	10	64	640	0.5	1850	170			
XIU30/800		632	922	82	878	722	30	30	22	22		678	65	10	72	72	801.5	798.5	8	80	640	0.5	1850	170			