

Inch Tapered Roller Bearing

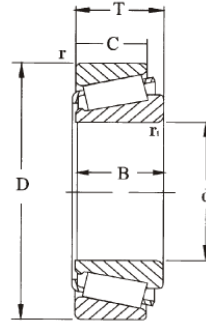

Выбрать	запрос	Подшипник No.	Граничные размеры (мм)							Грузоподъемность (кН)	
			д:	Б:	R	Д:	С	р	Т	Динамический (Cr)	Статический (Cor)
25580	44.45	25.4	0.8								
25522				83.058	19.114	3.5					
25520				82.931	19.05	3.5					
24780/20	41.275	23.02	0.8	76.2	17.462	3.5	22.225	65	80.5		
24780	41.275	23.02	0.8								
18790/20	50.8	17.462	1.5	85	13.495	3.5	17.462	49.5	65		
18790	50.8	17.462	1.3								
18720				85	13.495	3.5					
18690	46.038	17.462	1.5								
18620				79.375	13.495	2.8					
18590/20	41.275	17.462	1.5	73.025	12.7	3.5	16.667	46	55.5		
18590	41.275	17.462	1.5								
18520				73.025	12.7	3.5					
1780	25.4	19.837	1.3								
15245				62	14.288	0.8					
15243				61.912	14.288	0.8					
15126/245	31.75	20.638	1.3	62	14.288	0.8	19.05	46.5	54		
15126	31.75	20.638	1.3								
15125/245	31.75	20.638	1.3	62	14.288	3.5	19.05	46.5	54		
15125	31.75	20.638	1.3								
15123/245	31.75	19.05	1.3	62	14.288		18.161	46.5	54		
15123	31.75	19.05	1.3								
15106/245	26.988	20.638	1.3	62	14.288	0.8	19.05	46.5	54		
15106	26.988	20.638	1.3								
15103/245	26.157	20.638	1.3	62	14.288	0.8	19.05	46.5	54		
15103	26.157	20.638	1.3								

Inch Tapered Roller Bearing

15101/243	25.4	20.638	2	61.912	14.288	0.8	19.05	46.5	54
15101	25.4	20.638	2						
15100/245	25.4	20.638	1.3	62	14.288	3.5	19.05	46.5	54
15100	25.4	20.638	1.3						