

Medium size crossed cylindrical roller slewing bearings without a gear

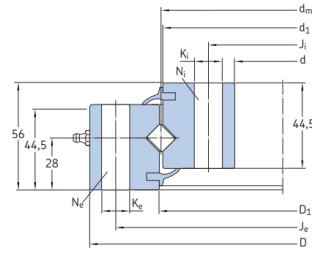

Выбрать	запрос	Обозначение	De(mm)	Dm(mm)	Di(mm)	Fe(mm)	he(mm)	Ne(mm)	Fi(mm)	hi(mm)	Ni(mm)	Вес (кг)	axial dyn. C(KN)	axial stat. Co(KN)	Fig N°	raceways (r)	bolt (b)
RKS.160.14.0414	484	414	344	460	14	24	368	14	24	28	K	229	520	1r	1b		
RKS.160.14.0544	614	544	474	590	14	32	498	14	32	38	K	270	680	2r	2b		
RKS.160.14.0644	714	644	574	690	14	36	598	14	36	44	K	290	800	3r	3b		
RKS.160.14.0744	814	744	674	790	14	40	698	14	40	52	K	315	930	4r	4b		
RKS.160.14.0844	914	844	774	890	14	40	798	14	40	60	K	340	1050	5r	5b		
RKS.160.14.0944	1014	944	874	990	14	44	898	14	44	67	K	360	1170	6r	6b		
RKS.160.14.1094	1164	1094	1024	1140	14	48	1048	14	48	77	K	390	1360	7r	7b		
RKS.160.16.1204	1289	1204	1119	1257	16	45	1151	16	45	124	L	386	1836	8r	8b		
RKS.160.16.1314	1399	1314	1229	1367	16	50	1261	16	50	135	L	419	1995	9r	9b		
RKS.160.16.1424	1509	1424	1339	1477	16	54	1371	16	54	146	L	494	2352	10r	10b		
RKS.160.16.1534	1619	1534	1449	1587	16	60	1481	16	60	158	L	611	2912	11r	11b		
RKS.160.16.1644	1752	1644	1536	1708	22	54	1580	22	54	214	L	658	3133	12r	12b		
RKS.160.16.1754	1862	1754	1646	1818	22	60	1690	22	60	228	L	1049	3354	13r	13b		
RKS.160.20.1904	2012	1904	1796	1968	22	64	1840	22	64	248	L	854	4066	14r	14b		